

# Live *The* Difference

## WITH A WELL-CONNECTED ADDRESS

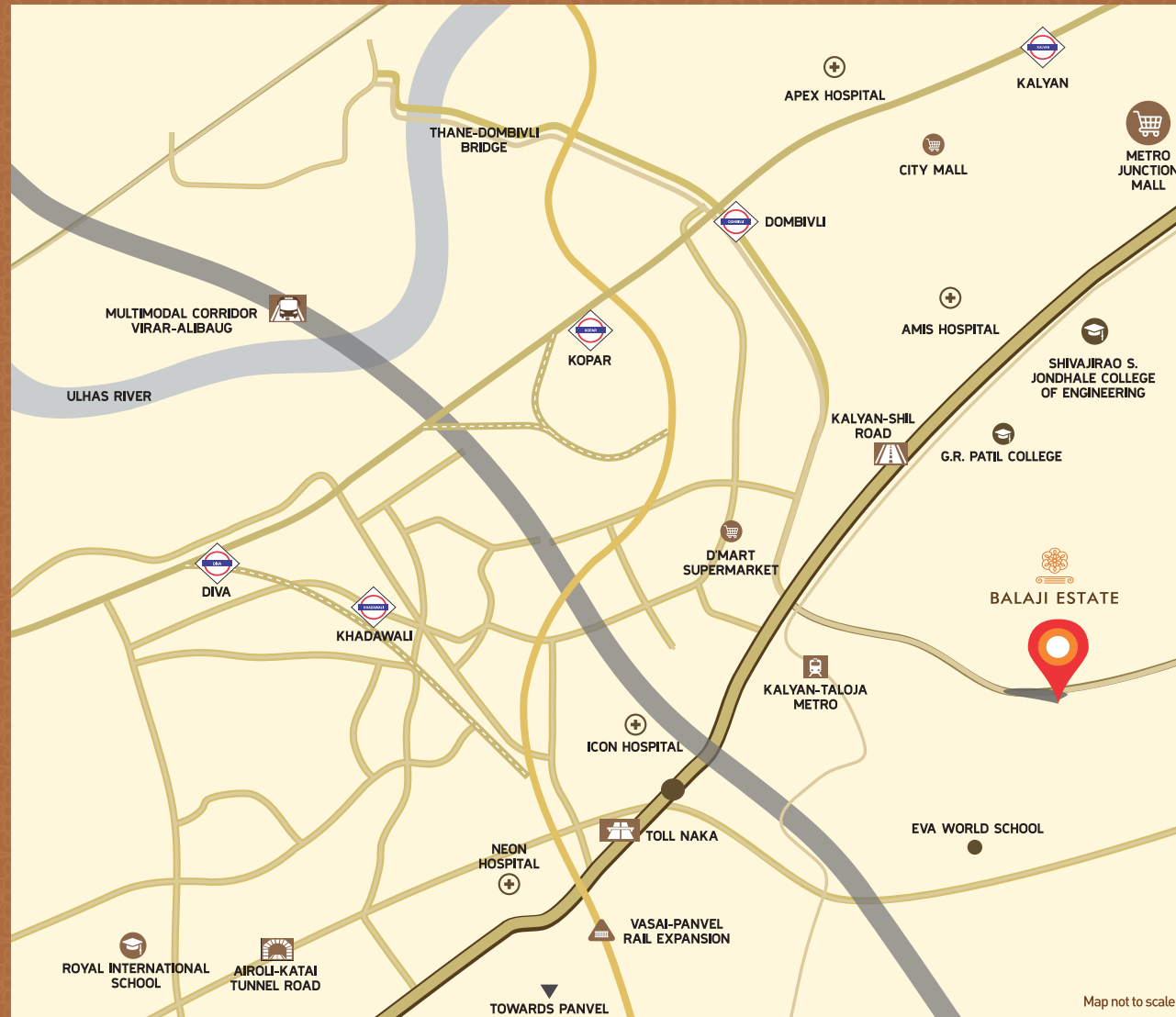

### CLOSE PROXIMITY TO

SCHOOLS / COLLEGES	HOSPITALS	MALLS
<ul style="list-style-type: none"> <li>Eva World School</li> <li>Royal International School</li> <li>G.R. Patil College</li> </ul>	<ul style="list-style-type: none"> <li>Shivajirao S. Jondhale College of Engineering</li> </ul>	<ul style="list-style-type: none"> <li>AIMS Hospital</li> <li>Apex Hospital</li> <li>Icon Hospital</li> <li>Neon Hospital</li> </ul>
		<ul style="list-style-type: none"> <li>City Mall</li> <li>D'Mart Supermarket</li> <li>Metro Junction Mall</li> </ul>

📞 **9819988988**

Site Office - Balaji Estate, Sai Balaji Buildcon, Khoni-Umbharli Road, Umbharli Gaon, Near Manpada, Dombivli East, Maharashtra - 421203.

Corporate Office - 1301, Casablanca, Plot 45, Sector 1, CBD Belapur, Opposite IDBI Bank, Navi Mumbai - 421204

Email - [contact@balaji-estate.com](mailto:contact@balaji-estate.com) | Web - [www.balaji-estate.com](http://www.balaji-estate.com)



MahaRERA Regn. No. - P51700031992 available on [www.maharera.mahaonline.gov.in](http://www.maharera.mahaonline.gov.in) |

NOTE / DISCLAIMER: The information herein i.e., specifications, designs, dimensions etc. are subject to change without notification as may be required by the relevant authorities or the developer's architect and cannot form part of an offer or contract, whilst every care is taken in providing this information. The owner, developer and manager cannot be held liable for variation. All illustrations & pictures are artist's impressions only. The items specified are subject to variations, modifications & substitution as may be recommended by the company's, architects / or relevant approving authorities.



# Live *The* Difference



Stock Image

FOR THOSE OF YOU WHO MAKE **THE DIFFERENCE**  
IT'S TIME FOR YOU TO LIVE ONE





## You believe, we create.

Asian Buildcon started in 2001 as a modest but strong, consistent, multi-faceted organization and committed to customer satisfaction. They have always banked on innovation, teamwork, a high degree of technical excellence and maintaining the highest standards of business practices. Today, Asian Buildcon is a renowned name in residential and commercial construction known for new concepts, innovative design, strong structure, modern amenities, quality construction and timely delivery.



The difference is in the details.

## Live *The* Difference

Imagine having a lifestyle-centric abode which you have always dreamt of. A place that truly makes a difference in your lifestyle. This residential bliss is all you need, with numerous state-of-the-art amenities lovingly manicured to exceed your highest expectations.







The legacy of  
**ASIAN BUILDCON.**

**MITA HEIGHTS**  
Kharghar, Navi Mumbai

**DREAM HEIGHTS**  
Kharghar, Navi Mumbai

**SAI PRASAD**  
Kharghar, Navi Mumbai

**RASHI HEIGHTS**  
Kharghar, Navi Mumbai

**MITA CHS**  
Kharghar, Navi Mumbai

**ASIAN INFOTECH PARK**  
Nerul, Navi Mumbai

**MEERA PLAZA**  
Kharghar, Navi Mumbai

**ASIAN HOUSE COMMERCIAL**  
Nerul, Navi Mumbai

**OM SRISHTI**  
Kharghar, Navi Mumbai

**MEERA ENTERPRISES** ASIAN GALAXY B  
Kharghar, Navi Mumbai



# A location that has it all !

The difference between a good location and an impeccable location is that it's more than mere connectivity. With upcoming government projects and metro station we are building you a today, for your better tomorrow.

## Live *The* Difference



Smooth connectivity to Kalyan-Dombivli Municipal Transport



Well-connected to Navi Mumbai, Thane & Kalyan



Close proximity to Navi Mumbai International Airport



New Railway Corridor connecting Western & Central Line



Approved Metro Corridor



Thane-Bhiwandi-Kalyan Monorail Corridor



Proposed Mumbai Trans-Harbour Link



Close to Top Schools, Colleges and Hospitals



10 Min Drive to Dombivli, Diva & Kopar Stations

### PROXIMITY TO STAT

Dombivli Railway Station | 10 MIN DRIVE

Kopar Railway Station | 10 MIN DRIVE

Metro Station | 3 MIN DRIVE



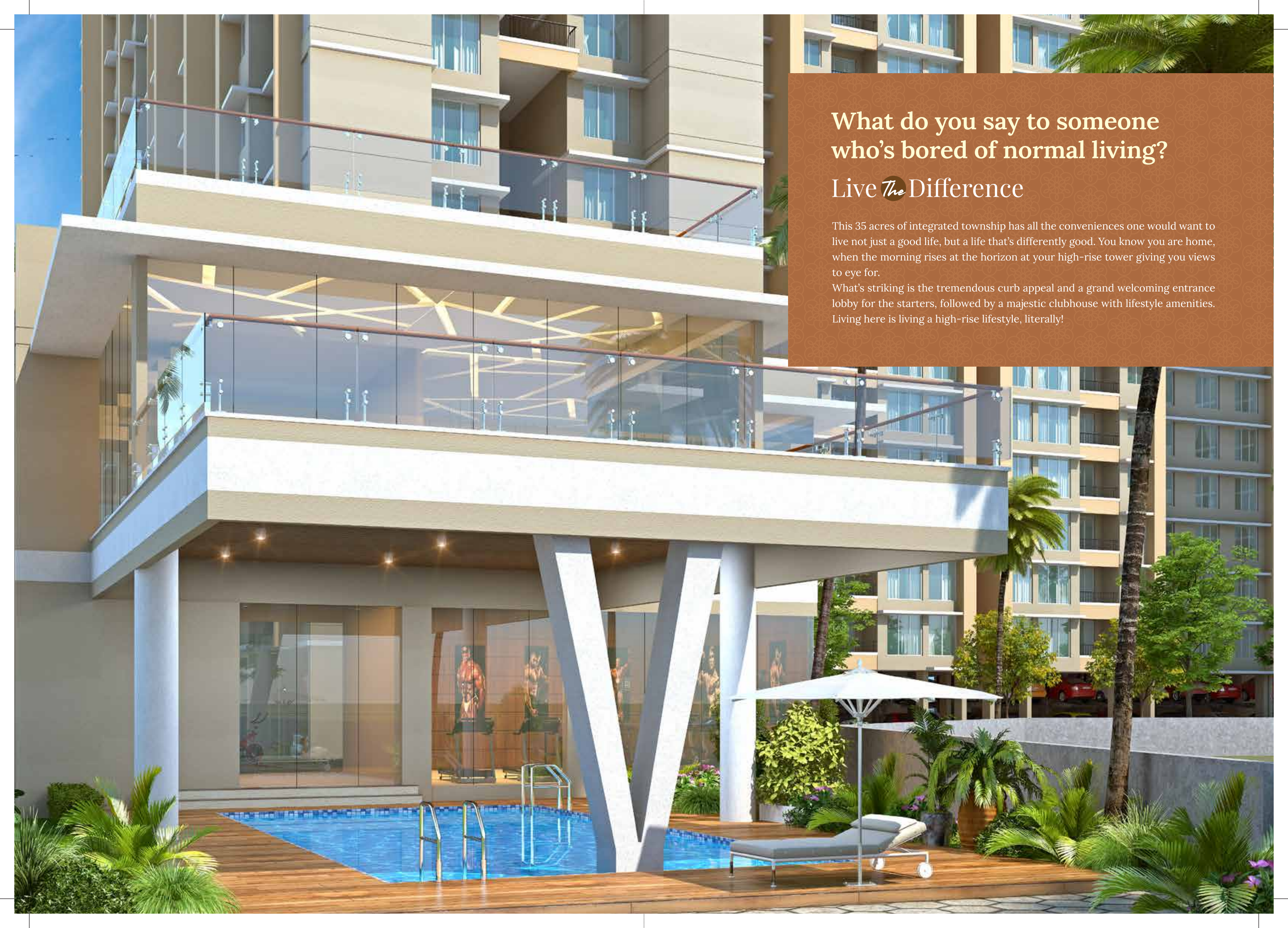

What do you say to someone  
who's bored of normal living?

Live *The* Difference

This 35 acres of integrated township has all the conveniences one would want to live not just a good life, but a life that's differently good. You know you are home, when the morning rises at the horizon at your high-rise tower giving you views to eye for.

What's striking is the tremendous curb appeal and a grand welcoming entrance lobby for the starters, followed by a majestic clubhouse with lifestyle amenities. Living here is living a high-rise lifestyle, literally!



CLUBHOUSE

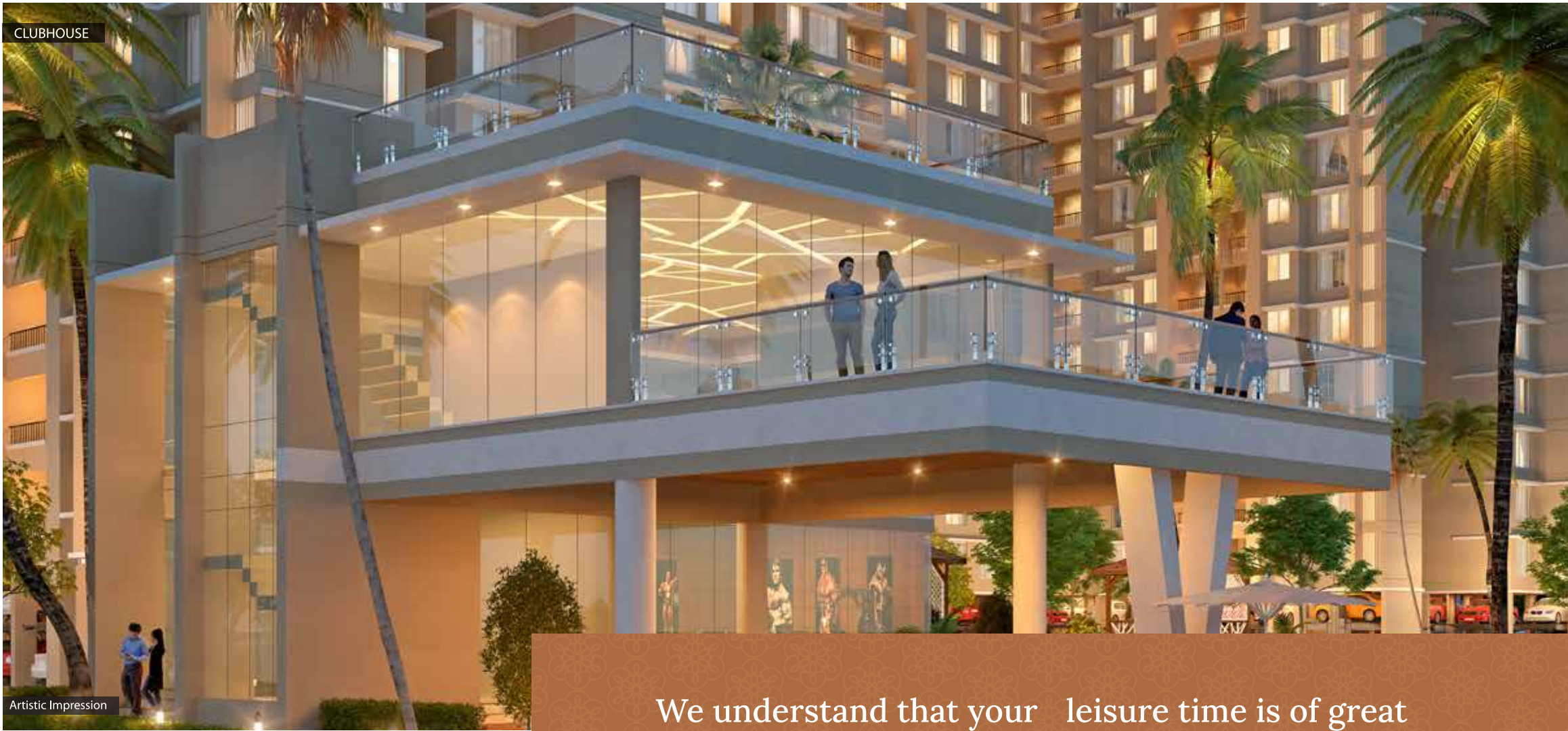

Artistic Impression

GYMNASIUM

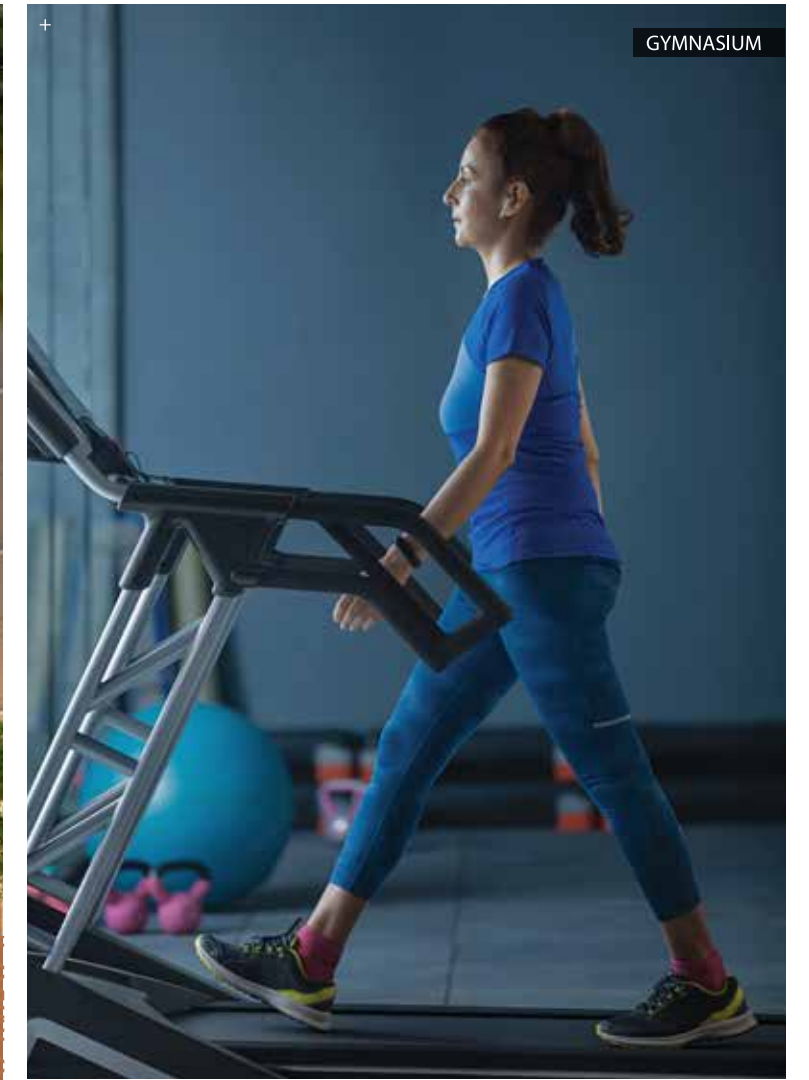

We understand that your leisure time is of great importance for you, to experience the joy of living

SWIMMING POOL



YOGA DECK

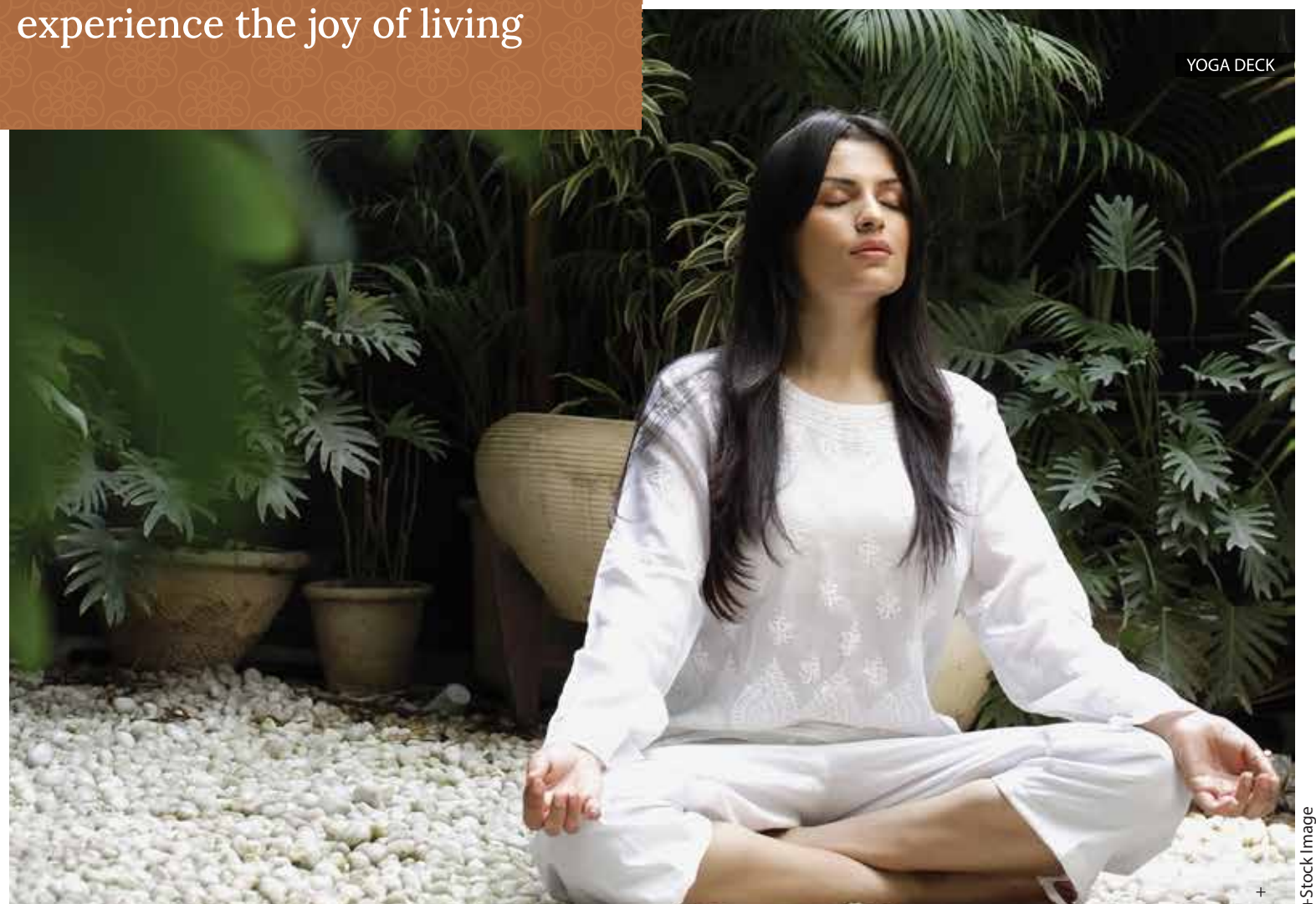

+ Stock image



# MASTER PLAN



24.00 M. WD. ROAD

12.00 M. WD. ROAD



WING - 'A'

WING - 'B'

WING - 'E'

WING - 'D'

WING - 'C'



# 1 BHK UNIT PLAN

# 1 BHK UNIT PLAN



R.C.A + TERRACE = 423 + 42 = 465 SQ.FT.



R.C.A + TERRACE = 428 + 42 = 470 SQ.FT.



# 1 BHK UNIT PLAN



R.C.A = 291 SQ.FT.

# 1 BHK UNIT PLAN



R.C.A = 365 SQ.FT.



# 1 BHK UNIT PLAN

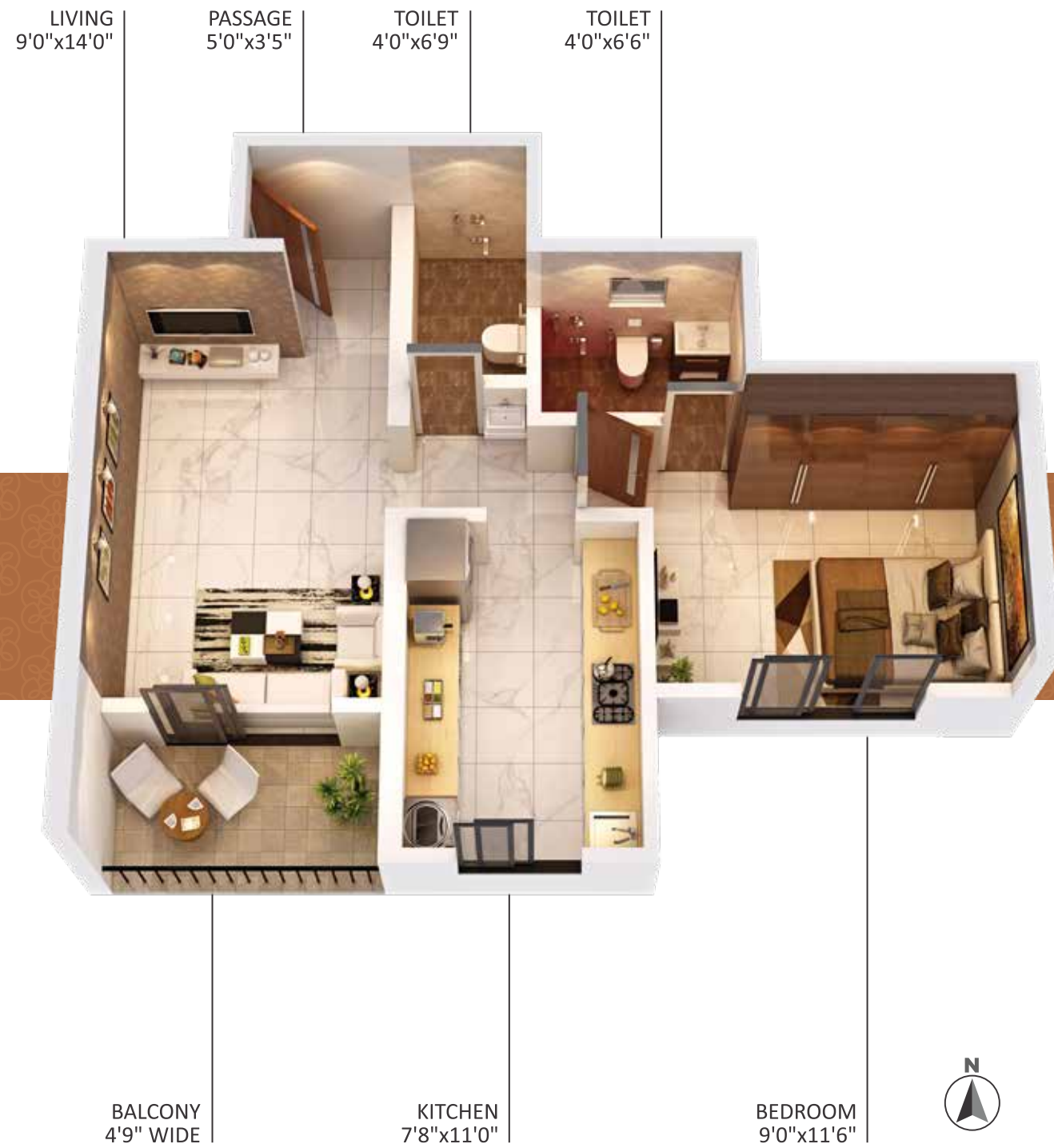

R.C.A + TERRACE = 449 + 42 = 491 SQ.FT.

# 2 BHK UNIT PLAN



R.C.A + TERRACE = 527 + 42 = 569 SQ.FT.





**BALAJI ESTATE**  
PHASE - II



Artistic Impression

## PROJECT AT A GLANCE

### Project Hallmarks

- Welcoming Entrance Lobby
- Clubhouse With Lifestyle Amenities
- Landscape Garden
- Children's Play Area
- Ample Parking Spaces
- Earthquake Resistant Construction

### External Features Structural

- Railing in Balcony
- Sliding Windows & Doors

### Paints & Exteriors

- Gypsum Plaster on Walls with Paint
- Water Proof Paint on External Walls

### Security & Surveillance

- 24x7 CCTV Surveillance System in common areas
- Intercom Facility
- Security with High Tech Applications

### Elevators

- Hi-speed Lifts with Power Backup

### Internal Features

- Vastu Compliant Homes
- Integrated Intercom Facility
- Vitrified Flooring in all Rooms

### Kitchen

- Granite Platform with SS Sink

### Bathrooms & Fixtures

- Branded Bathroom Fixtures
- Concealed Plumbing
- Full Height Ceramic Tiles

### Electricals & Fittings

- Concealed Copper Wiring
- Branded Electricals Fittings